



Wilmington Neighborhood Council

544 N. Avalon Boulevard, Suite 103, Wilmington, California 90744
(310) 522-2013 WilmingtonNC@empowerLA.org
www.wilmingtonneighborhoodcouncil.com

BEAUTIFICATION COMMITTEE MEETING

Tuesday, February 13th, 2018 @ 6:30 P.M.

Wilmington Branch Library

1300 N Avalon Blvd, Wilmington, CA 90744

AGENDA

- 1. Call to Order/Roll Call of Committee Board Members**
- 2. Public comment on non-agenda items**
- 3. Discussion & Action to recommend to the Governing Board:**
 - A) Adopt a Street**
 - a. updates on campaign**
 - B) Discussion on 2018 goals**
 - a. Clean ups**
- 4. Discussion on direction and goals of committee:**
 - A) Establish stakeholder membership in committee meetings**
 - a.. identify community members that wish to be on the committee**
- 6. Announcements from Governing Board Members**
- 7. Agenda items to consider for future meetings**
- 8. Adjourn**

PUBLIC INPUT AT NEIGHBORHOOD COUNCIL MEETINGS - The public can address the Committee on any agenda item before the Committee takes an action on an item. Comments from the public on agenda items will be heard only when the respective item is being considered. Comments from the public on other matters not appearing on the agenda will be heard during the General Public Comment period. Please note that under the Brown Act, the Committee is prevented from acting on a matter that you bring to its attention during the General Public Comment period; however, the issue raised by a member of the public may become the subject of a future Committee meeting. Public comment is limited to 2 minutes per speaker, unless adjusted by the Committee Chair.

THE AMERICAN WITH DISABILITIES ACT-As a covered entity under Title II of the Americans with Disabilities Act, the City of Los Angeles does not discriminate on the basis of disability and upon request, will provide reasonable accommodation to ensure equal access to its programs, services, and activities. Sign language interpreters, listening devices, or other auxiliary aids and/or services may be provided upon request, Please make your request at least 3 business days (72 hours) prior to the meeting you wish to attend by contacting the Department of Neighborhood Empowerment at 213 978-1551 email: WilmingtonNC@empowerLA.org

PUBLIC ACCESS OF RECORDS - In compliance with government code section 54957.5, non-exempt writings that are distributed to all or a majority of the Board members in advance of a meeting may be viewed at our website by clicking on the following link: at a location given in the item number of the agenda or at the scheduled meeting. In addition if you would like a copy of any record related to an item on the Agenda, please contact the Wilmington Neighborhood Council at WilmingtonNC@empowerLA.org.

PUBLIC POSTING OF AGENDAS–Wilmington Neighborhood Council agendas are posted for public review as follows: Banning High School, 1527 Lakme Avenue The Municipal Building 544 N. Avalon blvd., Wilmington Senior Center 1371 Eubank Street, Wilmington Public Library on 1300 Avalon Blvd., Los Angeles Harbor College, 1111 Figueroa Place. You can also receive our agenda on our web at: Wilmingtonneighborhoodcouncil.com and face book Wilmington neighborhood council.

RECONSIDERATION AND GRIEVANCE PROCESS: For information on Wilmington Neighborhood Council's process for board action reconsideration, stakeholder grievance policy, or any other procedural matters related to this Council, please see our web site. The Bylaws are available our website Wilmingtonneighborhoodcouncil.com **contact us at WilmingtonNC@empowerLA.org**

SERVICIOS DE TRADUCCION Si requiere servicios de traducción, favor de avisar al Concejo Vecinal 3 días de trabajo (72 horas) antes del evento. Por favor contacte a the (213) 978-1551 por correo electrónico para avisar al Concejo Vecinal. Or WilmingtonNC@empowerLA.org

Plant List:		
Symbol	Species	Size
T	Callistemon citrinus Lemon Bottlebrush	15 Gal

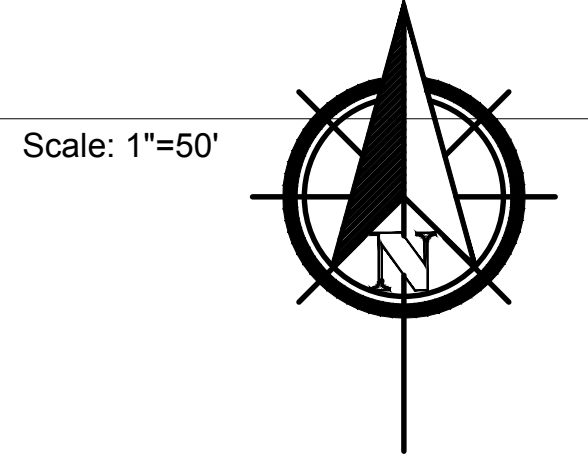
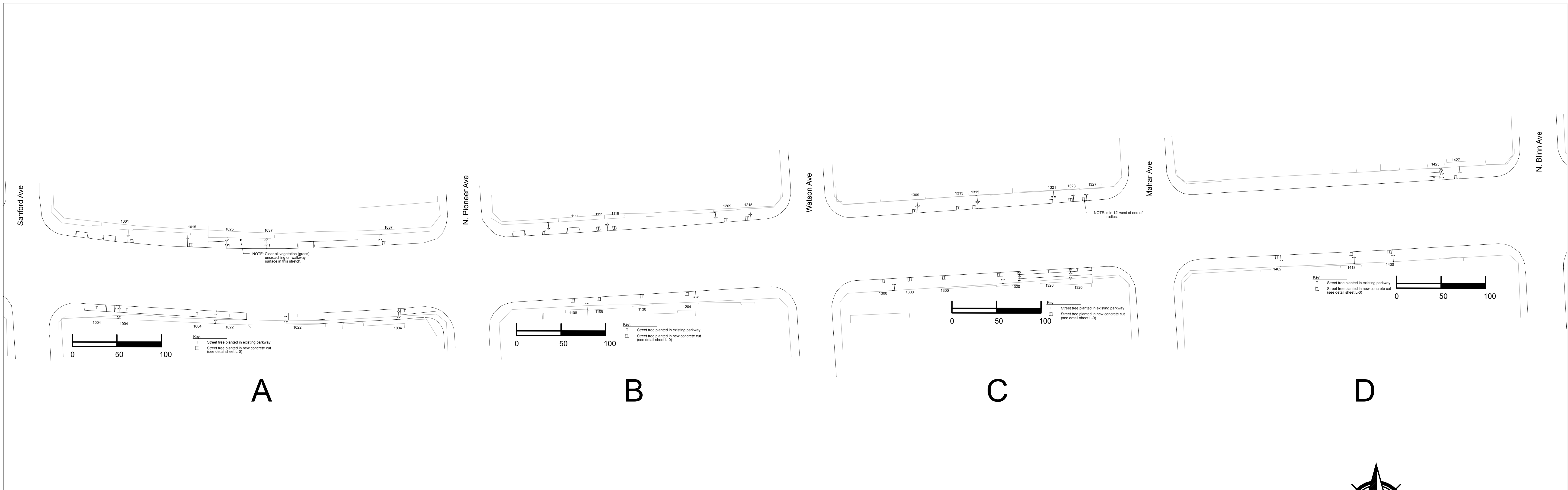
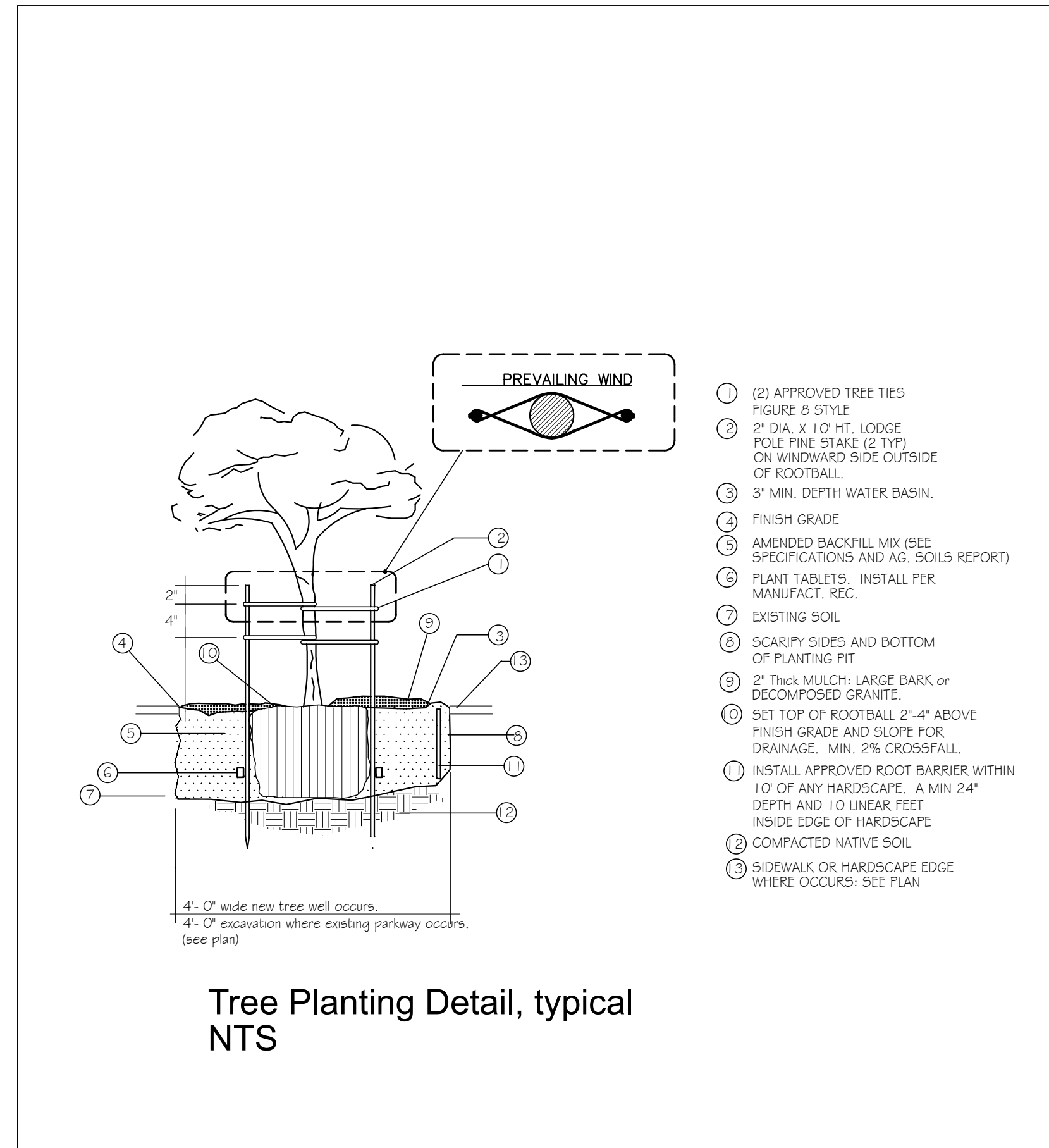

Pacific Coast Highway Beautification

Wilmington, Los Angeles, CA

Client:
Sharefest

Landscape Architect:
Dakeluna
535 Euclid Ave
Los Angeles, CA 90063
(323) 526-8279
glen@dakeluna.com

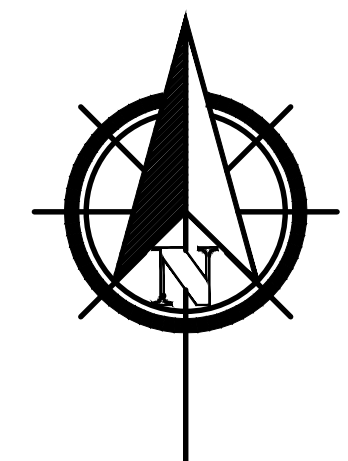
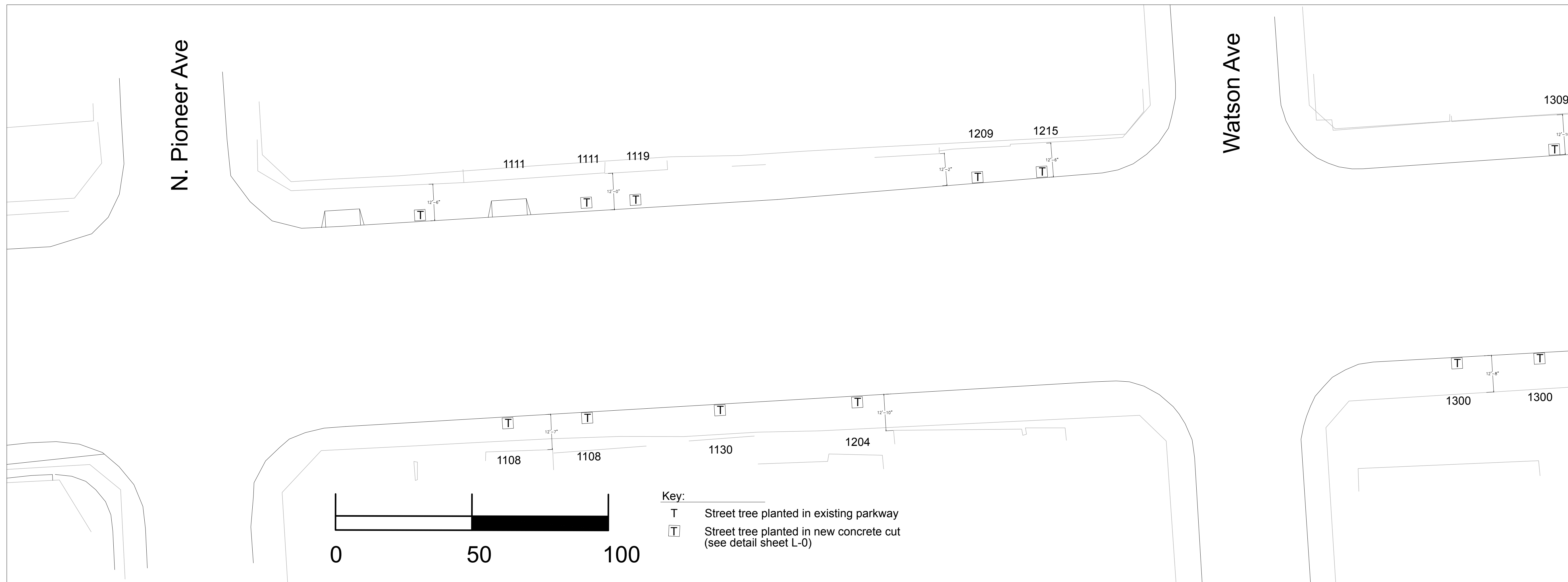
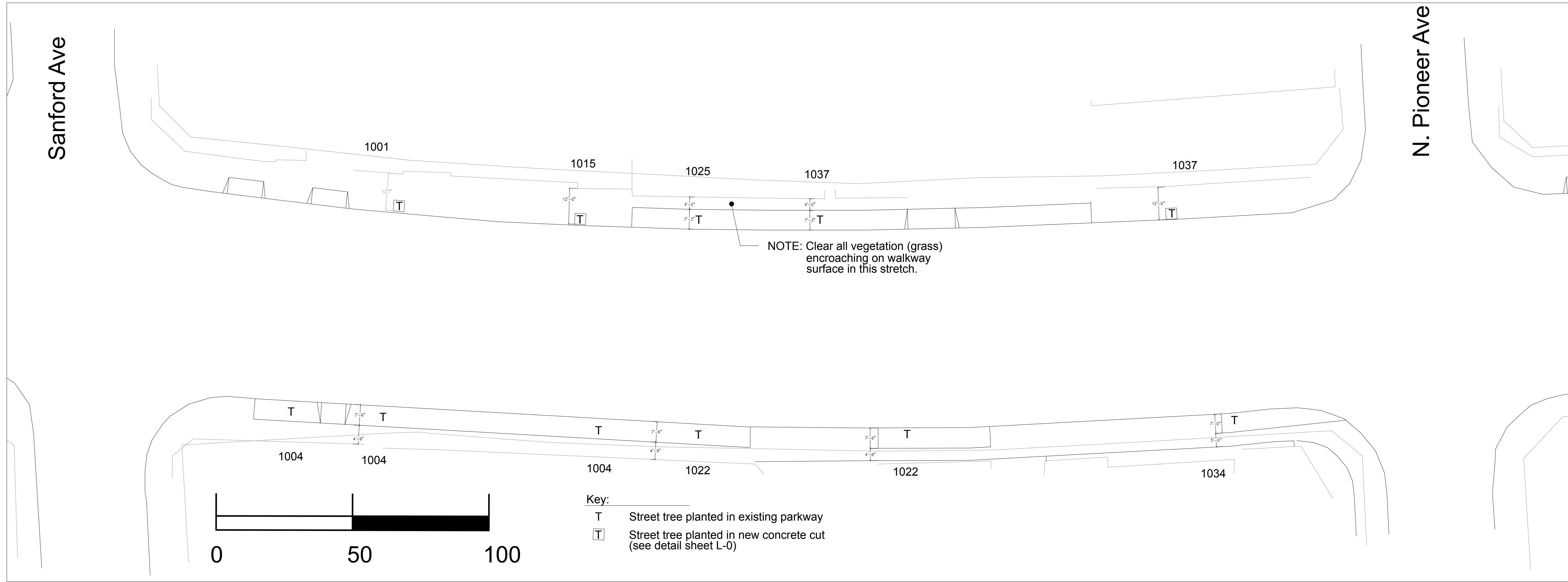

Tree Layout Plan

Date: 10/18/17

L-1

Pacific Coast Highway Beautification

Wilmington, Los Angeles, CA

Client:
Sharefest

Landscape Architect:
DakeLuna
535 Euclid Ave
Los Angeles, CA 90063
(323) 526-8279
glen@dakeluna.com

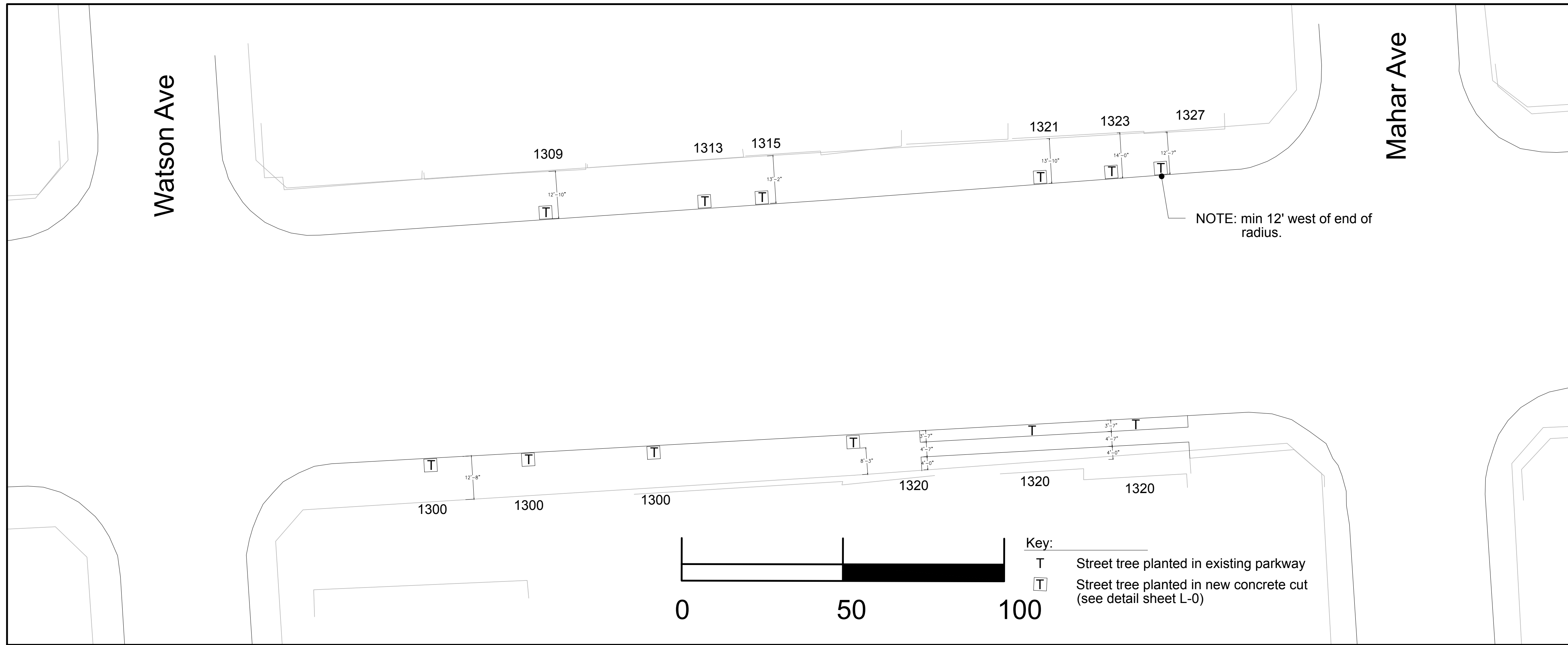

Scale: 1"=20'

C

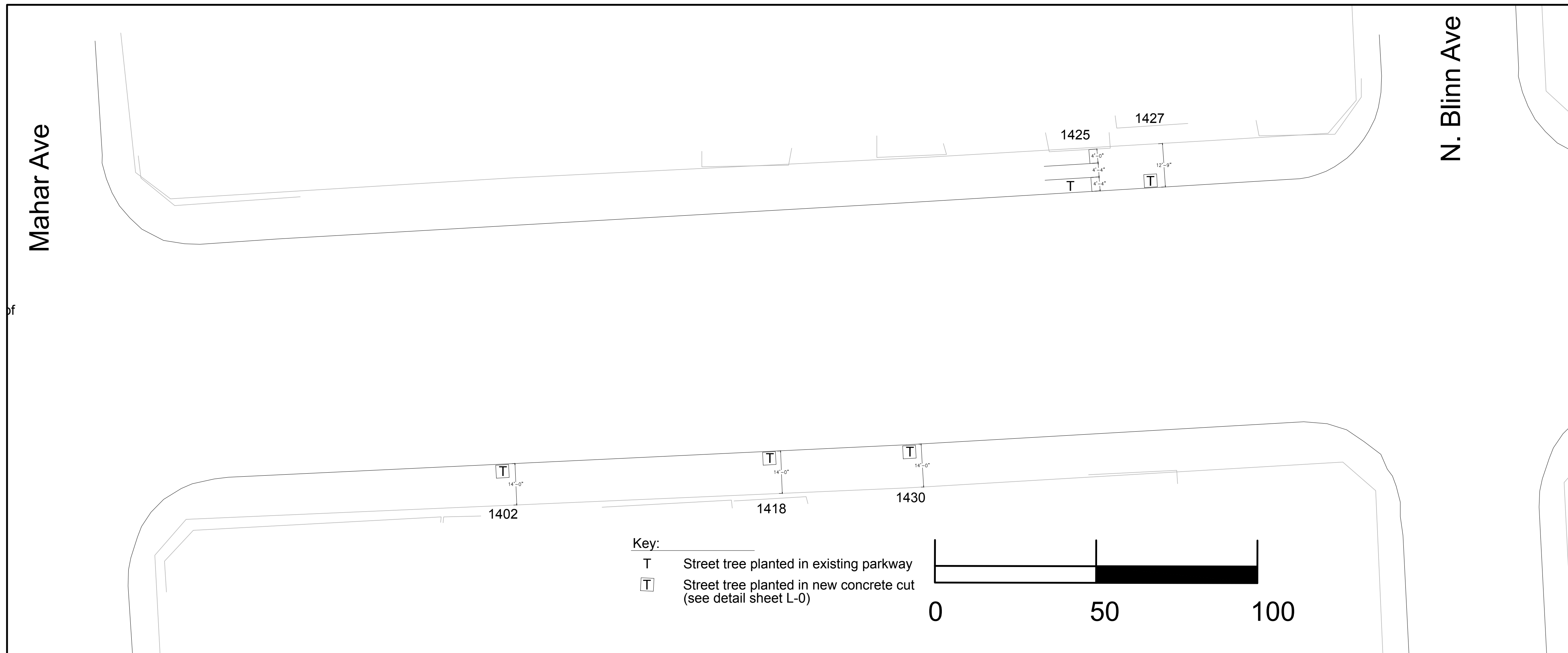

Scale: 1"=20'

D

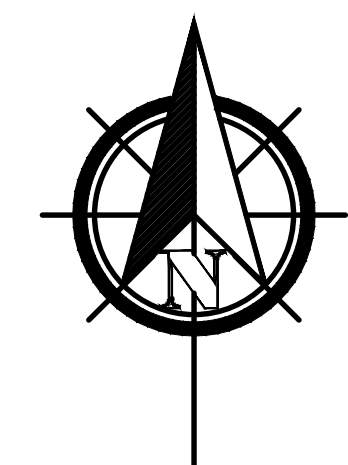

Tree Layout Plan

Date: 10/18/17

L-2